

## Tin Interface with Hanger Bolt M8\*150 for Metal Purlin

### Assembly

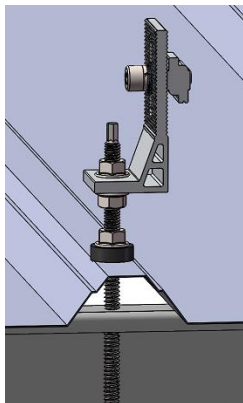

### Component



Tin Interface A with Hanger Bolt M8\*150 for Metal Purlin and screw M8\*25  
Part No.: ER-I-05A-8/25/HB/MP

### Technical Specification

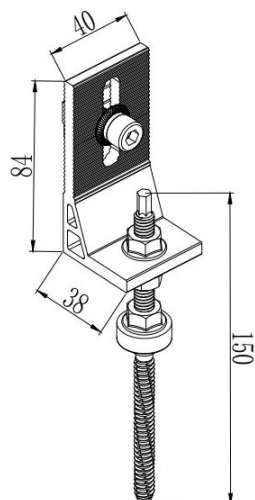
Application	Tin and Tile Roof	
Purlin Requirement	Metal Purlin	
Screw Specification	1 x Hanger Bolt for metal purlin M8*150 (with 3 nuts, round EPDM rubber pad, mounted)	
Dimensions	Tin Interface A: W38*L40mm Hanger Bolt: M8*150mm	
Weight	0.163 kg	
Packaging	40 units per pack, 4 packs (160 units) per carton	
Material	Hanger Bolt: SUS304 Tin Interface A: AL6005-T5 Waterproof Gasket: EPDM	
Standard	GB50797   AS NZS1170.2-2011   EN1991   JISC8955   ASCE 7-10	